

MONZA®

MONZA® BOLT ACTION RIFLE OWNER'S MANUAL

Model :

Serial No:

Purchased from :

Date of purchase :

Monza® is a registered trademark of Istanbul Arms Co. All rights reserved. This manual or any portion there of may not be reproduced or used in any manner whatsoever without the express written permission of Istanbul Arms Co.

CONTENTS

Warnings	4
Overview	6
Terminology	6
Serial Number	6
First Cleaning and Lubrication	6
Using the Safety	6
Firing Pin Assembly	7
Removing the Bolt	7
Dissassembly of the Bolt	8
Assembly of the Bolt	8
Installing the Bolt into Receiver	9
Ammunition	9
Loading the Magazine	9
Taking a Cartridge from Magazine into Chamber	10
Firing	11
Unload the Chamber	11
Unload the Magazine	11
Trigger Adjustment	11
Stock Removal and Installation	12
Butt Plate Removal	13
Comb Raiser	13
Picatinny Rail	14
Comb Exploded Picture and Part List	15
Exploded Picture	16
Exploded Part List	17

WARNING



-Don't forget that safety of your firearm is always your responsibility.

-Always keep the muzzle of your firearm pointed in a safe direction even though you are certain it is unloaded.

-Please carefully follow safety rules below. It may cause serious injury or death otherwise.

-Always keep your firearm safe from children and access of third parties.

-Always use safety goggles and earplugs when firing your rifle.

-Do not use your firearms under influencofalcohol or other drugs that may affect consciousness, don't let anybody else use it.

-Never shoot to a hard surface, water, trees, air or randomly.

-It is dangerous to alter your firearm mechanically. These guns are also excluded from warranty.

-Make sure that regular maintenance is being done and always use proper ammunition.

WARNING



-Don't forget that firearm safety starts with mechanical safety. Make sure that your safety is on when you don't use the rifle.

-Never think that your rifle is empty. You can only be sure that it's empty by checking the magazine and chamber visually.

-Never rely totally on your firearm's mechanical "safety" device. Like any mechanical device, a "safety" can sometimes fail; it can be jarred or inadvertently manipulated into an unsafe condition.

-Never transfer your firearms in a vehicle when it is loaded, even when stored in a holster or gun case of any kind.

-Whenever you handle any firearm, or hand it to someone, always open the action immediately and visually check the firearm's chamber to make certain that it is completely unloaded.

-Dropping or jarring a loaded firearm can cause accidental discharge.

WARNING



-Hunting from elevated surfaces such as treestands is dangerous.

-Beware of barrel obstructions. Before checking for a barrel obstruction, be certain your firearm is completely unloaded, there is no cartridge in the chamber and the "safety" is in the on safe position.

-Be alert to the signs of ammunition malfunction. If you detect an off sound or light recoil when a cartridge is fired, do not load another cartridge or shell into the chamber.

-The caliber of your firearm is marked on the barrel. Never insert a cartridge of the incorrect caliber into any firearm. Use only SAAMI or CIP approved ammunition.

-Make sure of adequate ventilation in the area that you discharge a firearm. lead exposure can occur from discharging firearms in poorly ventilated areas, cleaning firearms or handling ammunition.

-Keep your fingers away from the trigger while loading and unloading unless shooting is imminent.

WARNING 

- Be sure of your target and backstop, particularly during low light periods.
- Always unload your firearm’s chamber before crossing a fence, climbing a tree, jumping a ditch or negotiating other obstacles.
- Be certain your firearm is unloaded before cleaning.
- We reserve the right to refuse service on firearms that have been altered, added to or substantially changed.
- Practice periodic maintenance, avoid unauthorized servicing.
- Do not, under any circumstances, alter the trigger, “safety” or other parts of the firing mechanism of this or any other firearm. Failure to obey this warning may result in injury or death to yourself or others.
- Clean your firearm after every shooting day.
- Use lubricants made especially for firearms.
- Excess usage of lubricants can collect the dust. It may cause damage to barrel.

WARNING 

- Regular maintenance and cleaning prolongs to lifetime your rifle.
- Firearms must be handled responsibly and securely stored to prevent access by children and other unauthorized users.
- California has strict laws pertaining to firearms, and you may be fined or imprisoned if you fail to comply with them. Visit the Web site of the California Attorney General at <https://oag.ca.gov/firearms> for information on firearm laws applicable to you and how you can comply.

Prevent child access by always keeping guns locked away and unloaded when not in use. If you keep a loaded firearm where a child obtains and improperly uses it, you may be fined or sent to prison.

ADVERTENCIA 

Las armas de fuego deben de ser manipuladas responsablemente y almacenadas en sitios seguros para prevenir el acceso a ellas por parte de niños y personas sin autorización.

California cuenta con leyes estrictas sobre las armas de fuego, y puede ser multado y encarcelado si no las obedece. Visite la página web de California Attorney General, <https://oag.ca.gov/firearms> para más información sobre cómo cumplir con las leyes de armas de fuego.

Prevenga el acceso de los niños a las armas de fuego manteniéndolas siempre en un lugar seguro, bajo llave y descargadas cuando no estén en uso. Si usted deja un arma cargada al alcance de un niño, y éste la utiliza indebidamente, usted podría ser multado e incluso enviado a la cárcel.

If you have questions or comments, please feel free to write us.
info@kfi-usa.com



Scan QR to watch how to videos



OVERVIEW

You can be certain that Monza, made using precision manufacturing with modern technology, will satisfy your shooting needs.

The Monza is a bolt-action rifle that operates by lifting the bolt handle, drawing the bolt rearward and then sliding the bolt forward and rotating the bolt handle downward until it stops. This process takes a cartridge from the magazine and loads it into the chamber for firing.

Read user manual carefully before loading the gun with ammunition. It is important to know basic mechanics of the gun before pulling the trigger. Assembly and disassembly of required parts is explained in this user manual later.

TERMINOLOGY

In traditional firearm terminology, movement of the parts occurs with the firing in horizontal position. Barrel is forward or in front, stock is rear or backwards, trigger is down, sights are on upside of the rifle. For general parts terminology, refer to figure on this page.

SERIAL NUMBER

Your rifles unique serial number is marked on the barrel, receiver and bolt. You can follow all procedures based on this number regarding firearms regulations.

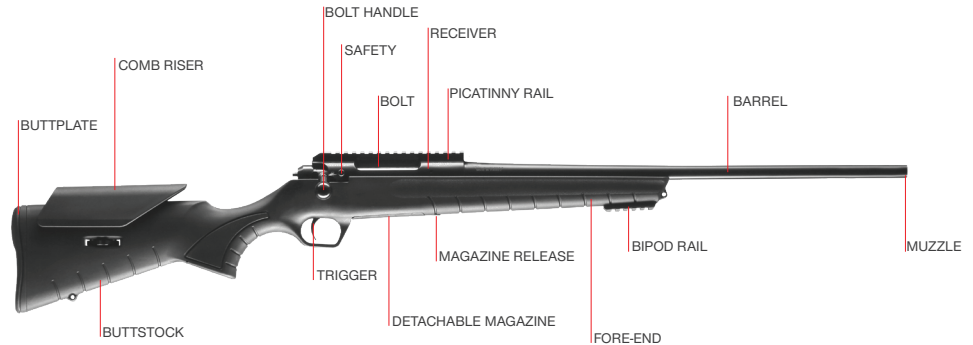

FIRST CLEANING AND LUBRICATION

WARNING



PLEASE FOLLOW BELOW INSTRUCTIONS BEFORE CLEANING YOUR RIFLE.

Be careful and use proper lubricants when cleaning your rifle. Avoid contact of the cleaners with eye and skin. Be mindful to use light lubricants especially in the outer surface of rifle. Rust removers, barrel solvents and lead removers can damage the coating on barrel and receiver.

WARNING



USE PROTECTIVE GLASSES WHEN CLEANING YOUR FIREARM. PINS AND SPRINGS MAY FLY OFF AS YOU REMOVE/DISSASSEMBLE SOME PARTS.

USING THE SAFETY

Safety mechanism is designed to prevent firing when it is in “on safe” position. Alongside with it, this mechanism is the most important part preventing accidental discharge if the gun is dropped, jarred or hit on a hard surface. Safety is on when you move the safety latch in shown direction, in this position “S” indicator can be seen.



Scan QR to watch how to videos

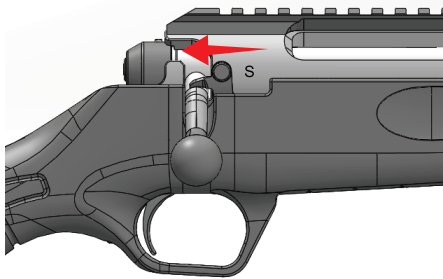

Picture 1: The "safety" shown in the on safe position. This exposes S on the receiver.

WARNING



NEVER RELY TOTALLY ON YOUR FIREARM'S MECHANICAL "SAFETY" DEVICE. LIKE ANY MECHANICAL DEVICE, A "SAFETY" CAN SOMETIMES FAIL; IT CAN BE JARRED OR INADVERTENTLY MANIPULATED INTO AN UNSAFE CONDITION.

Safety is OFF when you move the safety latch forward in shown direction. Red marker shows that rifle is ready to fire.

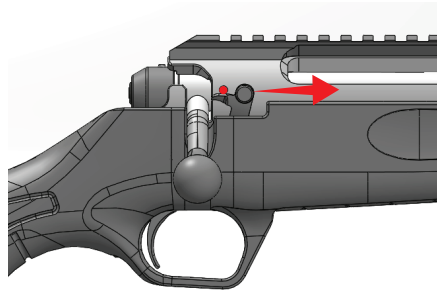

Picture 2: The "safety" shown in the off safe position. This exposes red indicator on receiver.

This safety system also locks the bolt in closed position. Bolt can not be moved up, down, forward or backwards. With single movement, both firing and bolt mechanisms are locked.

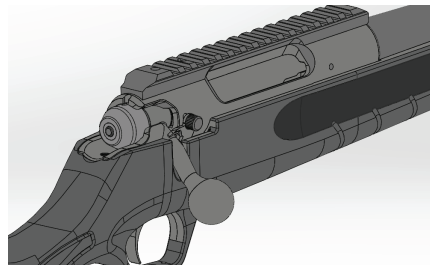

Picture 3: Safety is on and bolt can't be moved.

FIRING PIN ASSEMBLY

Firing pin is cocked with lifting the bolt counter clockwise. Firing pin follower extracts from its container and red indicator becomes visible that shows firing pin is ready.

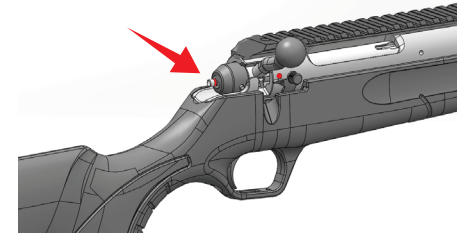

Picture 4: Cocking the firing pin.

REMOVING THE BOLT

Holding the bolt release button on the left side of receiver, pull the bolt backwards to remove it from the receiver.

WARNING



ALWAYS KEEP THE MUZZLE OF YOUR FIREARM POINTED IN A SAFE DIRECTION EVEN THOUGH YOU ARE CERTAIN IT IS UNLOADED.



Scan QR to watch how to videos

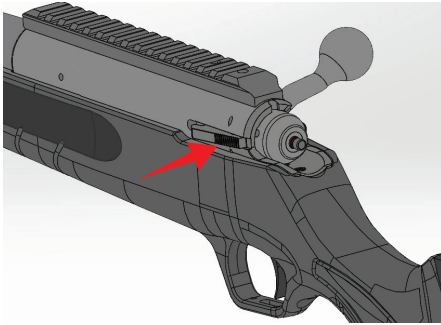

Picture 5: Push bolt release latch in shown direction.

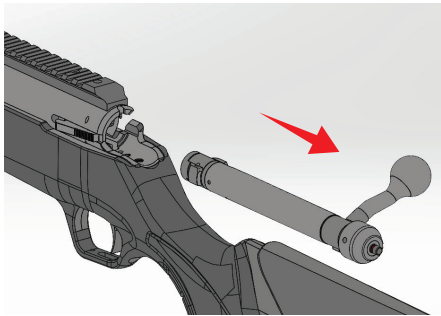

Picture 6: Bolt is removed from receiver by pulling backwards.

DISSASSEMBLY OF THE BOLT

- 1- Push and turn firing pin spring cap in shown direction.
- 2- Spring in the firing pin assembly will push the firing pin and follower outside of the bolt.
- 3- Remove the spring, firing pin follower and firing pin.

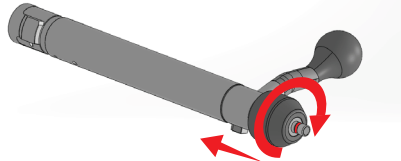

Picture 7: Push and turn firing pin spring cap in shown direction



Picture 8: Spring in the firing pin assembly will push the firing pin and follower outside of the bolt.

ASSEMBLY OF THE BOLT

- 1- Install the firing pin as shown so that it is in cocked position.
- 2- Place the firing pin spring and firing pin follower to their position.
- 3- Push and turn firing pin spring cap in counter clockwise to lock it into position.

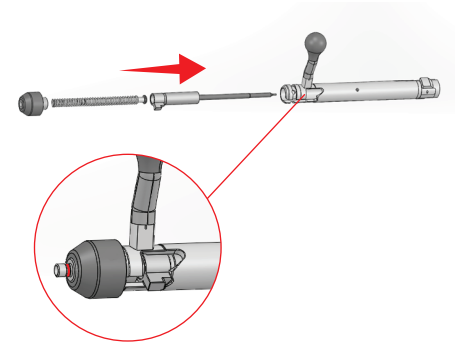

Picture 9: Firing pin assembly is placed in position as shown into bolt.



Scan QR to watch how to videos

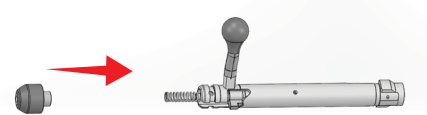

Picture 10: Firing pin spring cap is installed onto bolt.

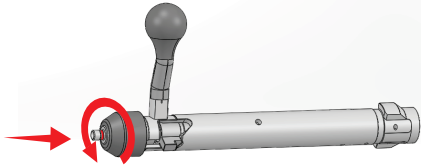

Picture 11: Push and turn firing pin spring cap in counter clockwise to lock it into position.

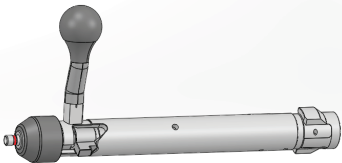

Picture 12: Bolt is ready to mount on receiver.

INSTALLING THE BOLT INTO RECEIVER

Bolt is placed into its slot as shown in the Picture and turned clockwise to lock into position.

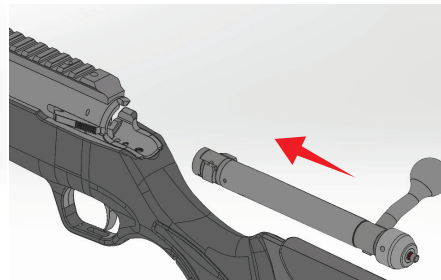

Picture 13: Bolt group is placed to receiver as shown.

AMMUNITION

Barrel and receiver of this rifle is tested for high pressure. Ammunition that is not approved by CIP or SAAMI will not be accepted as standard ammunition.

WARNING



DO NOT USE AMMUNITION OTHER THAN WHAT IS INSCRIBED ON THE BARREL. EXAMINE EVERY CARTRIDGE YOU PUT IN YOUR FIREARM. HAND-LOADED, RELOADED OR NON-STANDARD AMMUNITION MAY CAUSE SERIOUS INJURY. ALWAYS WASH YOUR HANDS AFTER TOUCHING THE AMMUNITION.

LOADING THE MAGAZINE

Always point the muzzle in a safe direction and keep your finger off the trigger when loading a firearm. It may cause serious injury or even death to ignore this warning. Never transport your rifle with a loaded chamber. Keep the safety on when carrying.

- 1-Release the magazine by pushing the magazine release button.
- 2-Insert cartridges as in the Picture
- 3-Make sure that tips of the cartridges are not outside of the magazine.



Scan QR to watch how to videos

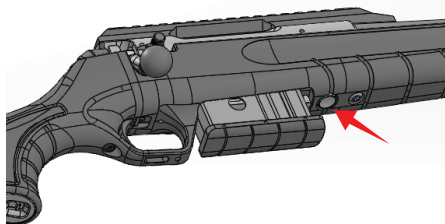

Picture 14: Magazine is released by pushing the button in Picture.

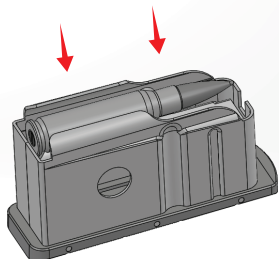

Picture 15: Ammunition is loaded into magazine by pushing from above as in the picture.

TAKING A CARTRIDGE FROM MAGAZINE INTO CHAMBER

- 1-Install the loaded magazine into it's slot as shown in Picture 16.
- 2-If you won't fire immediately, put the safety on.
- 3-When safety is off, open the mechanism by pulling the bolt upwards and rearwards.
- 4-Slide the bolt forward and then downward to put a cartridge in chamber.
- 5-Put the safety on again.

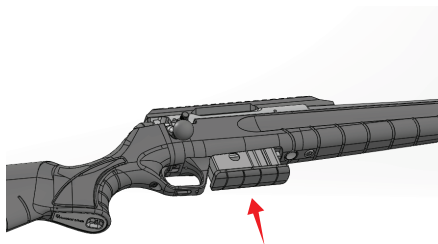

Picture 16: Magazine is placed into it's slot.

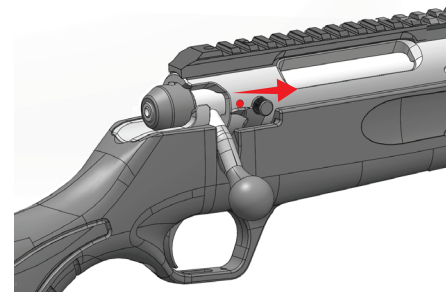

Picture 17: Safety OFF.

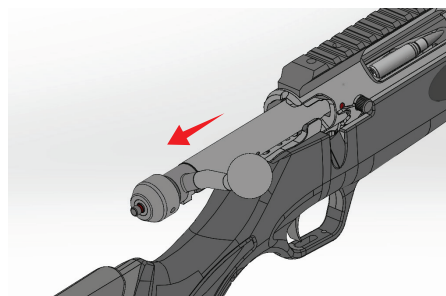

Picture 18: By pulling the bolt rearward and forward again, a cartridge placed into chamber. Pull the bolt down clockwise to lock.



Scan QR to watch how to videos

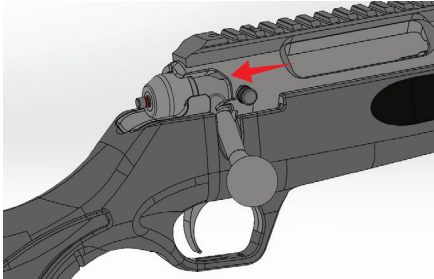

Picture 19: Safety ON.

FIRING

WARNING



MAKE SURE THE MUZZLE IS POINTED IN A SAFE DIRECTION AND ENVIRONMENT IS SAFE FOR SHOOTING.

- 1-Load the cartridge into chamber
- 2-Put the safety OFF
- 3-Aim at your target and squeeze the trigger slowly
- 4-To continue shooting, pull the bolt handle upwards – rearwards to eject empty case.
- 5-Slide the bolt forward-down to put another round from the magazine into chamber.

WARNING



AFTER SHOOTING ALL THE ROUNDS. PULL THE BOLT BACK TO VISUALLY CHECK CHAMBER AND MAGAZINE TO MAKE SURE NO AMMUNITION LEFT.

UNLOAD THE CHAMBER

- 1-If you decide not to shoot when a round is chambered, simply remove the magazine.
- 2-Pull the bolt backwards to clear the round from chamber.

UNLOAD THE MAGAZINE

- 1-Push magazine release button on the rifle to remove magazine.
- 2-Push the cartridges in shown direction to remove them from magazine.

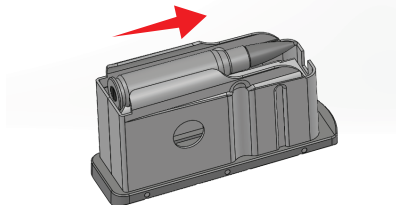

Picture 20: Unloading the magazine.

TRIGGER ADJUSTMENT

1- LENGTH OF PULL

This setting allows you to move the trigger forward-backward 9.5 mm in total. Use 2 mm allen wrench to make this adjustment.

- 1-Loosen the screw shown in Picture to release the trigger.
- 2-Move the trigger to desired position.
- 3-Tighten the screw to fix trigger in position

WARNING



MAKE SURE THE CHAMBER AND MAGAZINE ARE EMPTY WHEN ADJUSTING TRIGGER.

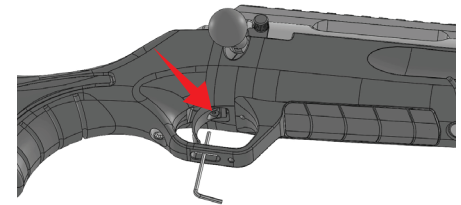

Picture 21: Length of pull adjustment.



Scan QR to watch how to videos



2- OVERTRAVEL PULL WEIGHT

- 1-Remove the bolt from receiver.
- 2-Use 2.5 mm allen wrench to adjust overtravel pull force.
- 3-Overtravels toughness is increased by turning the screw clockwise, decreased by turning counter-clockwise.

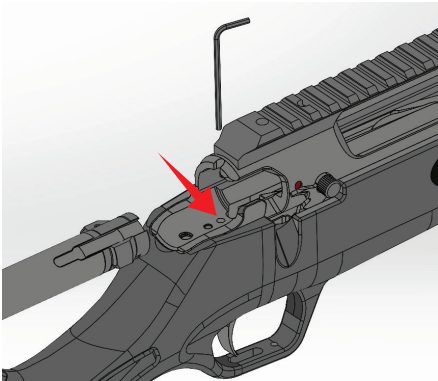

Picture 22: Overtravel pull weight adjustment.

3- TRIGGER PULL WEIGHT

This setting allows the trigger pull weight to be adjusted between 1.2 kg - 2.4 kg's. Use 2 mm allen wrench to make this adjustment. Trigger pull force can be increased by turning counter-clockwise, decreased by turning clockwise.

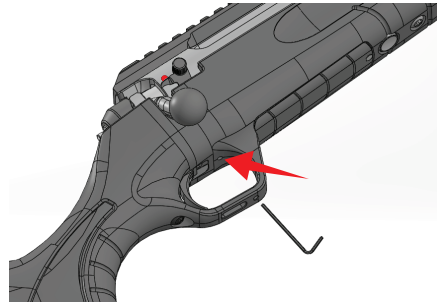

Picture 23: 1.5mm allen wrench goes into shown hole for adjusting trigger pull weight.

STOCK REMOVAL AND INSTALLATION

Use T30 T-handle wrench to remove shown screws to separate receiver and stock.

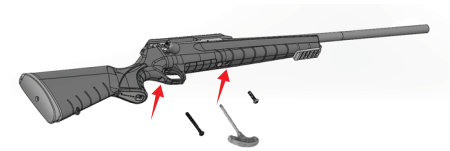

Picture 24: Two screws connecting receiver and stock should be removed.

By holding firmly, separate the body and stock.

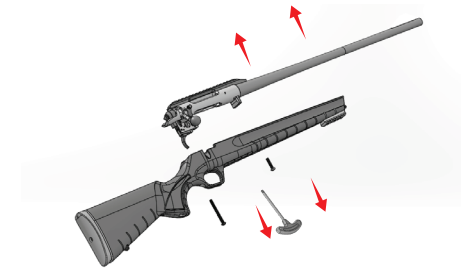

Picture 25: Stock and body separated.



Scan QR to watch how to videos

BUTT PLATE REMOVAL

Butt plate can be removed using phillips screwdriver.



Picture 28: Butt plate is removed from the stock.

OPTIONAL COMB RISER

For the installation of Monza comb riser;

- 1- Remove the butt plate.
- 2- Remove Monza tags on the stock by pushing them from inside out.
- 3- Pull and remove the fixed comb from the stock. Comb riser and stock is now ready for installation.
- 4- Insert the mechanism of the riser in stock as

shown in picture.

5- Place rotating wheel nut in it's slot.

6- Place the comb on top of the stock.

7- Adjust the height of cheek riser by turning the wheel nut.

Remove the fixed comb by pulling upwards.

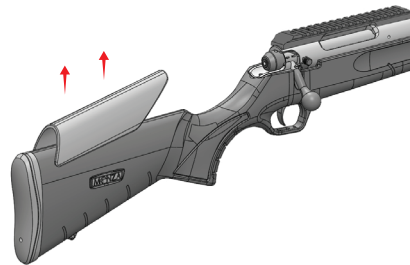

Picture 29: Pull and remove the fixed comb from the stock.

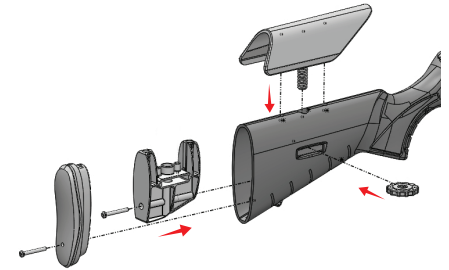

Picture 30: Instalattion scheme of cheek riser.

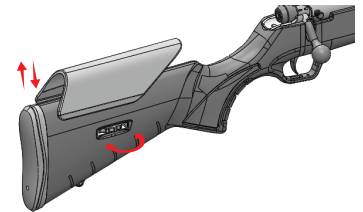

Picture 31: Height adjustment of cheek riser.



Scan QR to watch how to videos

PICATINNY RAIL

Monza comes equipped with MIL-STD 1913 Picatinny rail on top. It can be removed and replaced with other types of mounts if desired.

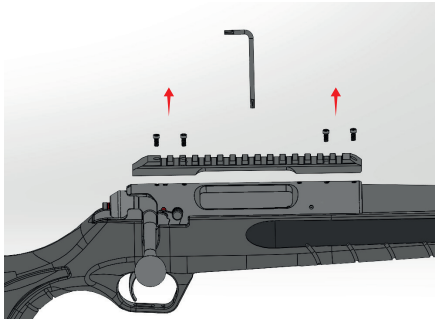

Picture 32: Picatinny rail can be separated for mount replacement.



Scan QR to watch how to videos

COMB GROUP

1	COMB RISER	1
2	RECOIL PAD	1
3	INSERT	2
4	ADJUSTABLE CHEEK PIECE	1
5	ADJ. WHEEL NUT	1

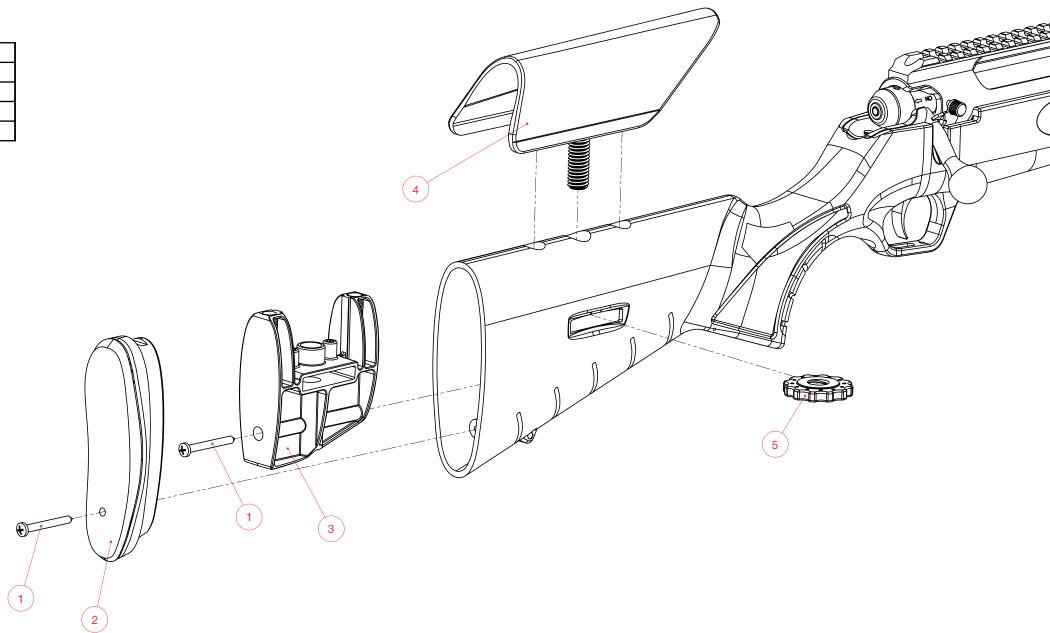



Scan QR to watch how to videos

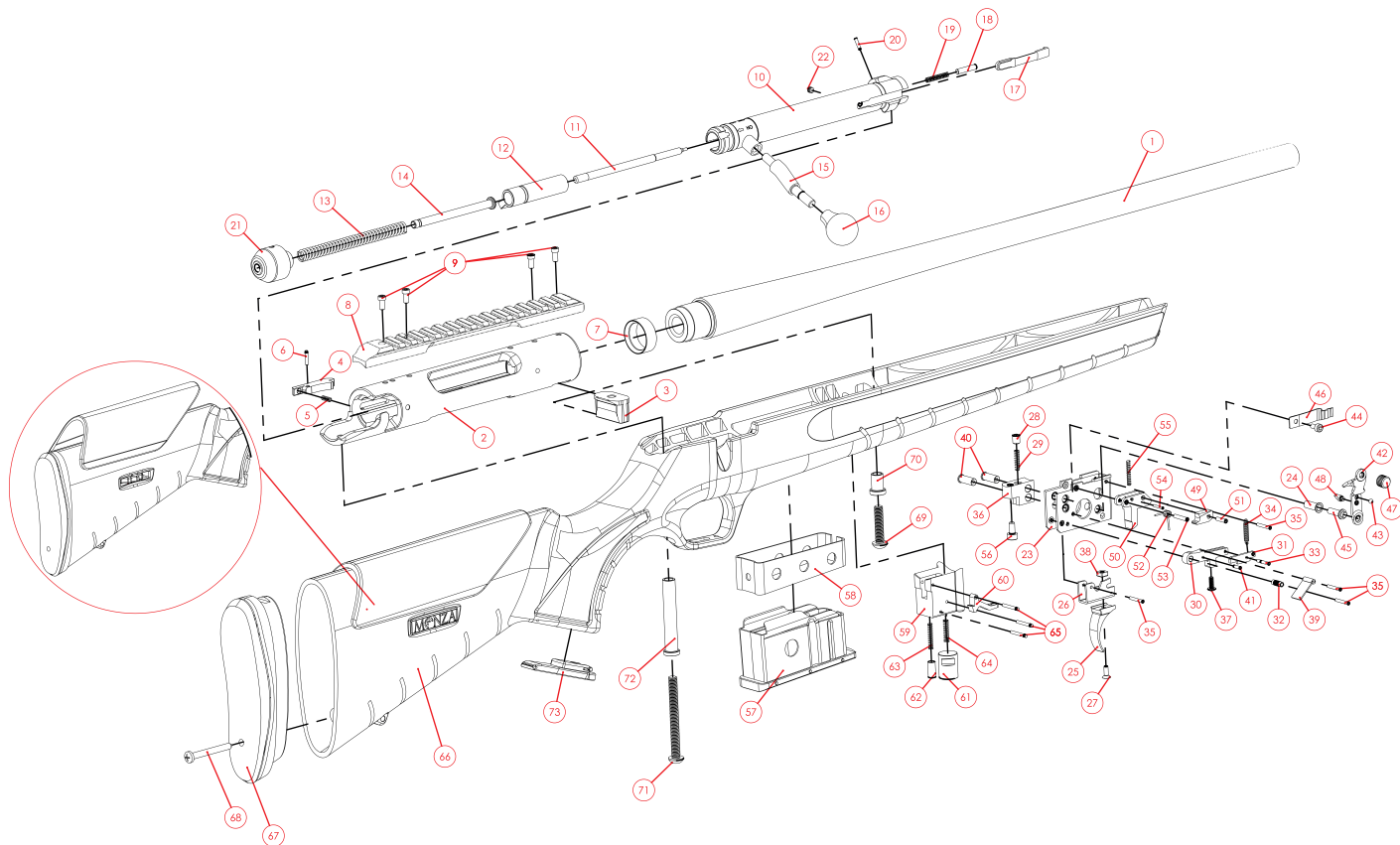



Scan QR to watch how to videos



	PART NAME	PCS
--	-----------	-----

BARREL GROUP

1	BARREL	1
---	--------	---

RECEIVER GROUP

2	RECEIVER	1
3	RECOIL LUG	1
4	BOLT STOP PLUNGER	1
5	BOLT STOP PLUNGER SPRING	1
6	BOLT STOP PLUNGER PIN	1
7	BARREL LOCK NUT	1
8	PICATINNY RAIL	1
9	PICATINNY RAIL SCREW	4

BOLT GROUP

10	BOLT	1
11	FIRING PIN	1
12	FIRING PIN STOP NUT	1
13	MAIN SPRING	1
14	FIRING PIN FOLLOWER	1
15	BOLT HANDLE BODY	1
16	BOLT HANDLE	1
17	EXTRACTOR	1
18	EJECTOR PIN	1
19	EJECTOR SPRING	1
20	EJECTOR LOCKING PIN	1
21	FIRING PIN CAP	1
22	EXTRACTOR SCREW	1

	PART NAME	PCS
--	-----------	-----

TRIGGER GROUP

23	TRIGGER HOUSING	1
24	TRIGGER HOUSING NUT	1
25	TRIGGER	1
26	TRIGGER PLATE	1
27	TRIGGER MOUNT SCREW	1
28	TRIGGER ADJUSTMENT SCREW	1
29	TRIGGER ADJUSTMENT SPRING	1
30	TRIGGER PILOT	1
31	TRIGGER PILOT SHEET	1
32	TRIGGER PILOT SLEEVE	1
33	TRIGGER PILOT SHEET PIN	1
34	TRIGGER PILOT SPRING	1
35	TRIGGER PILOT MAIN PIN	4
36	TRIGGER HOUSING CONNECTOR	1
37	OVERTRAVEL ADJUSTMENT SCREW	1
38	TRIGGER LOCK NUT	1
39	TRIGGER SHEET	1
40	TRIGGER HOUSING MAIN PIN	2
41	TRIGGER SHEET MOTION PIN	1
42	SAFETY SHEET	1
43	SAFETY BALL	1
44	SAFETY SCREW	1
45	SAFETY MAIN PIN	1
46	SAFETY SPRING SHEET	1
47	SAFETY BUTTON	1
48	SAFETY PIN	1
49	SAFETY SEAR	1
50	SEAR HOUSING	1
51	SEAR PIN	1
52	SEAR HOUSING SPRING	1
53	SEAR HOUSING PIN	1
54	SEAR HOUSING LOCK PIN	1
55	SEAR SPRING	1
56	TRIGGER HOUSING SCREW	1

	PART NAME	PCS
--	-----------	-----

MAGAZINE GROUP

57	MAGAZINE	1
58	MAGAZINE CASE	1
59	MAGAZINE HINGE	1
60	MAGAZINE CAM	1
61	MAGAZINE RELEASE BUTTON	1
62	MAGAZINE RELEASE PIN	1
63	MAGAZINE RELEASE SPRING	1
64	MAG. RELEASE BUTTON SPRING	1
65	MAG. RELEASE RETAINING PIN	3

STOCK GROUP

66	STOCK	1
67	RECOIL PAD	1
68	RECOIL PAD SCREW	1
69	RECEIVER MOUNT FRONT SCREW	1
70	MOUNT FRONT SCREW SLEEVE	1
71	RECEIVER MOUNT REAR SCREW	1
72	RECEIVER MOUNT REAR SLEEVE	1
73	PISTOL GRIP CAP	1

MONZA[®]

ISTANBUL SILAH VE SAVUNMA
SANAYI TIC. A.Ş.
DUDULLU OSB 1. CD NO:7
UMRANIYE/ISTANBUL/TURKEY
www.istanbulsilah.com

OFFICIAL US DISTRIBUTOR
KFI USA LLC
5415 W HOMOSASSA TRAIL UNIT B
LECANTO, FL 34461
352-419-4185
info@kfi-usa.com - www.kfi-usa.com